

Hammer Unions

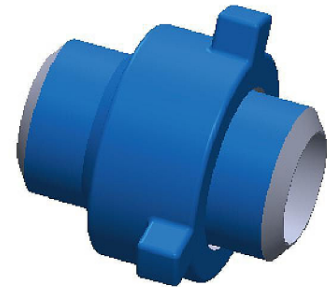

The hammer union are made of high quality steel forged by metal process. We offer a wide range of hammer unions: FIG602, FIG1002, FIG1003, FIG1502, FIG2002, FIG2202; rated: 5000Psi(35MPa),10000Psi(70MPa), and the end connections are available in line pipe thread and butt weld.

Fig 100 Hammer Union
1,000 psi (69 bar)
cold working pressure

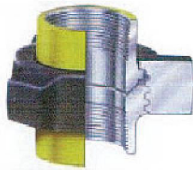

Fig 200 Hammer Union
2,000 psi (138 bar)
cold working pressure

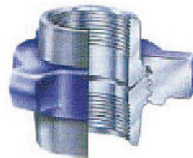

Fig 206 Hammer Union
2,000 psi (138 bar)
cold working pressure

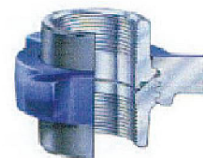

Fig 207 Hammer Union
2,000 psi (138 bar)
cold working pressure



Fig 211 Hammer Union
2,000 psi (138 bar)
cold working pressure

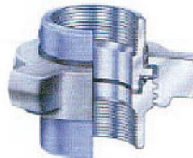

Fig 400 Hammer Union
1" - 4" 4,000 psi (276 bar)
5" - 12" 2,500 psi (172 bar)
cold working pressure



Fig 600 Hammer Union
6,000 psi (414 bar)
cold working pressure

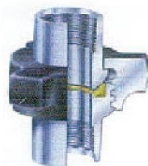

Fig 602 Hammer Union
6,000 psi (414 bar)
cold working pressure

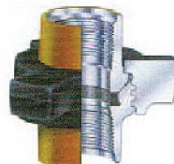

Fig 1002 Hammer Union
10,000 psi (690 bar)
cold working pressure

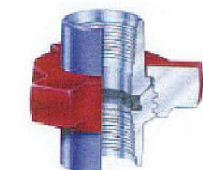

Fig 1003 Hammer Union
10,000 psi (690 bar)
cold working pressure



Fig 1502 Hammer Union
15,000 psi (1034 bar)
cold working pressure

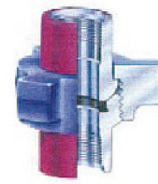
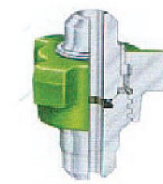

Fig 2002 Hammer Union
20,000 psi (1380 bar)
cold working pressure



Swivel Joints



Features

- ◇ available with sizes ranging from 1" to 4" and rated WP ranging from 2000psi–20000psi (14MPa–140MPa).
- ◇ Available in the models of style 10, style 50, and style 100, etc.
- ◇ End connections: thread connection and union connection.

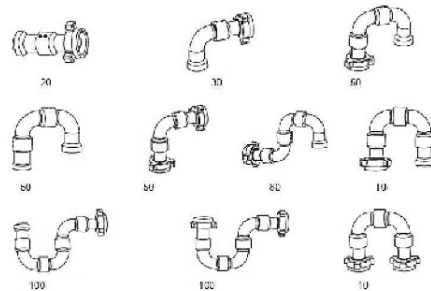

Steel Hose Loops and Pipe/Circulating Hose

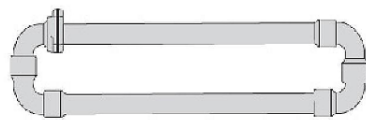

Typical Integral Construction

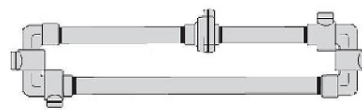

Typical Threaded Construction

Pup Joints

- ◇ Acceptable with integral, welded or NPST union end.
- ◇ connections from 10,000 to 15,000psi for standard and sour service.



Integral Fittings



Elbow



FFFM Cross



FMM Elbow



MF Elbow



Wyes Y